

Spring Advance Work Supports - 7,500 lb. Capacity

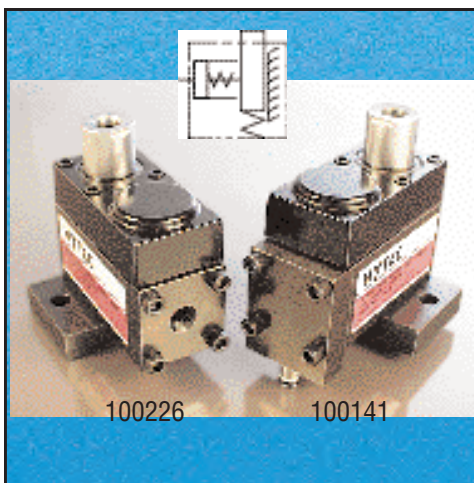

Work supports provide the stability that prevents deflection and vibration of the workpiece during machining. Automatically adjustable to varying sizes or positions of the workpieces, they are also usable as adjustable rest pads under clamps.

These 7,500 lb. work supports are available in four different spring advanced models with either conventional or manifold mounting. All use plunger seals to protect against contamination. The spring advance models use Hytec's diaphragm breather system.

The block style design requires only a flat surface for mounting rather than the large threaded hole necessary with threaded body designs.

Features:

- Spring advance models
- 7,500 lb. rated capacity at 5,000 psi max.
- Single-acting
- Manifold or conventionally mounted styles
- Sealed against contamination

Note: See Page 23 for crowned threaded insert.

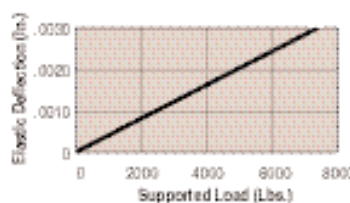

Avg. Performance
 1001.41, 1002.26, 1005.96

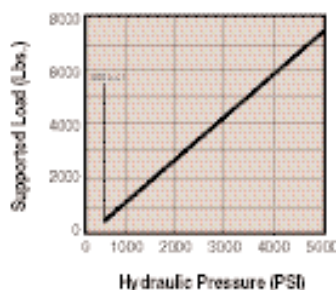

Performance
Work Support Nos.

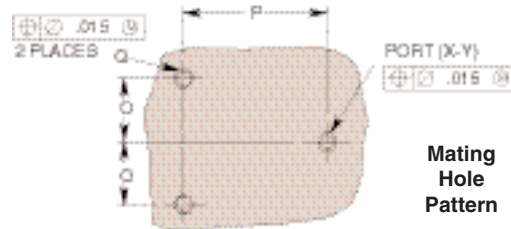
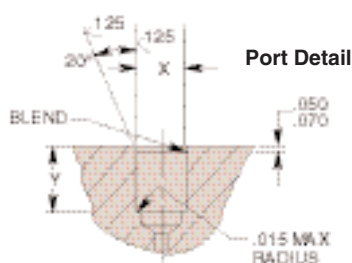
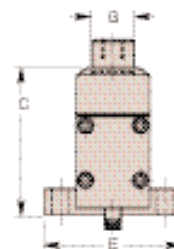
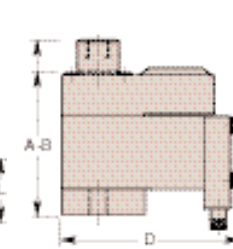
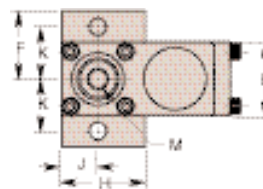
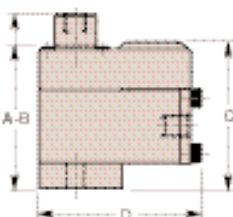
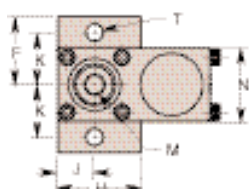

Mating Hole Pattern

Cat. No.	Specifications				Dimensions (In Inches)										
	*Cap. (Lbs.)	Oil Cap. (Cu. In.)	Advance System	Mounting	A Retract Oper. Range	B Advance Oper. Range	C	D	E	F	G Dia.	H	J	K	L
100226	7,500	.25	Spring	Conventional	3.435	4.185	3.500	3.875	3.250	1.625	1.000	2.000	.875	1.250	1.500
100926															
100141				Manifold				4.250							—
100998				Conventional				3.875							1.500

Cat. No.	Dimensions (In Inches)									
	M Thread		N	O Mounting	P Mounting	Q Thread Size	T Dia.	X		Y
	Size	Depth						Thread Size	Dia.	
100226	½-13UNC	.875	1.750	—	—	—	.406	¼ NPTF	—	—
100926				7/16-20 SAE-4	—	.375	.535			
100141				—	.375	.515				
100998	**M12x1.5 6H	.866		—	—	—	.406	**M12x1.5 6H	—	—

NOTE: * Based on 5,000 psi max. operating pressure.

**Per ISO 6149-1.

SPRING ADVANCE WORK SUPPORTS			
Cat. No.	Approximate Forces Required to Depress Plunger (Lbs.)		
	Fully Extended	Extended 50%	Fully Depressed
100226	5.0	7.0	9.0
100926			
100141			
100998			